



INSTRUCTIONS FOR:

NEMESIS Cutting system

Models: 4110,11,12,13,14,15,16,17,18,19

Thank you for purchasing a Trimalco product. Manufactured in the UK to a high standard this product will, if used according to these instructions and properly maintained, give you years of trouble free performance



IMPORTANT: PLEASE READ THESE INSTRUCTIONS CAREFULLY. NOTE THE SAFE OPERATIONAL REQUIREMENTS, WARNINGS & CAUTIONS. USE THE PRODUCT CORRECTLY AND WITH CARE FOR THE PURPOSE FOR WHICH IT WAS INTENDED. FAILURE TO DO SO MAY CAUSE DAMAGE OR PERSONAL INJURY, AND WILL INVALIDATE THE WARRANTY.

PLEASE KEEP INSTRUCTIONS SAFE FOR FUTURE USE. ONLY LIFT OR MOVE THE NEMESIS CUTTER RAIL USING THE CIRCULAR GRIP ON THE TOP OF THE RAIL. IF YOU NEED TO HANDLE THE CUTTER IN ANY OTHER WAY OR IF YOU NEED TO MOVE IT AWAY FROM ITS CUTTING TABLE, THE BLADE MUST BE REMOVED FIRST.

1. DO NOT REMOVE THE PACKAGING BANDS UNTIL INSTRUCTED (See A below)

2. CONTENTS

After unpacking the NEMESIS Cutting system, check to make sure that you have all the parts and that there is no damage to the machine.

2.1 NEMESIS Cutting system components:

Cutter rail, base and end plates assembly	RH & LH Handle assemblies	One (1) blade cartridge
Box of 100 utility blades	One (1) scoring blades	One (1) textile blade cartridge
One (1) textile blades	One (1) allen key (2mm)	

3. ASSEMBLY

- 3.1 Position the cutter on the table in its operating position, cut the packing bands and remove them from underneath the cutter. (See B below)
- 3.2 Using a 17mm spanner, fit a lifting handle to each end. Once tightened, the handles should move freely without any sideways movement. (See C below)
- 3.3 Check that the cutter is in the correct position on the table and check that the base plate and end plates are in line. (See D below)
- 3.4 Attach the two end plates to the table using the pan head screws provided. (See E below)
- 3.5 Check that each lifting handle operates correctly.
- 3.6 Remove the cutter from both guide rods by lifting vertically.
- 3.7 Using the countersink head screws provided, fix the base plate to the table. (See F below)
- 3.8 Check the grip of the Nemesis cutter rail by using an A4 piece of paper (this instruction sheet is ideal). Place the paper under one end of the Cutter rail and try to pull the paper free. The weight of the Cutter rail should be enough to grip the paper. Repeat this test along the entire length of the Cutter rail and if necessary use paper, plastic or card spacers under the full width of the base to make it level.
- 3.9 If you want to make the table top flush with the aluminium base plate, build up the table using 6mm MDF or similar.

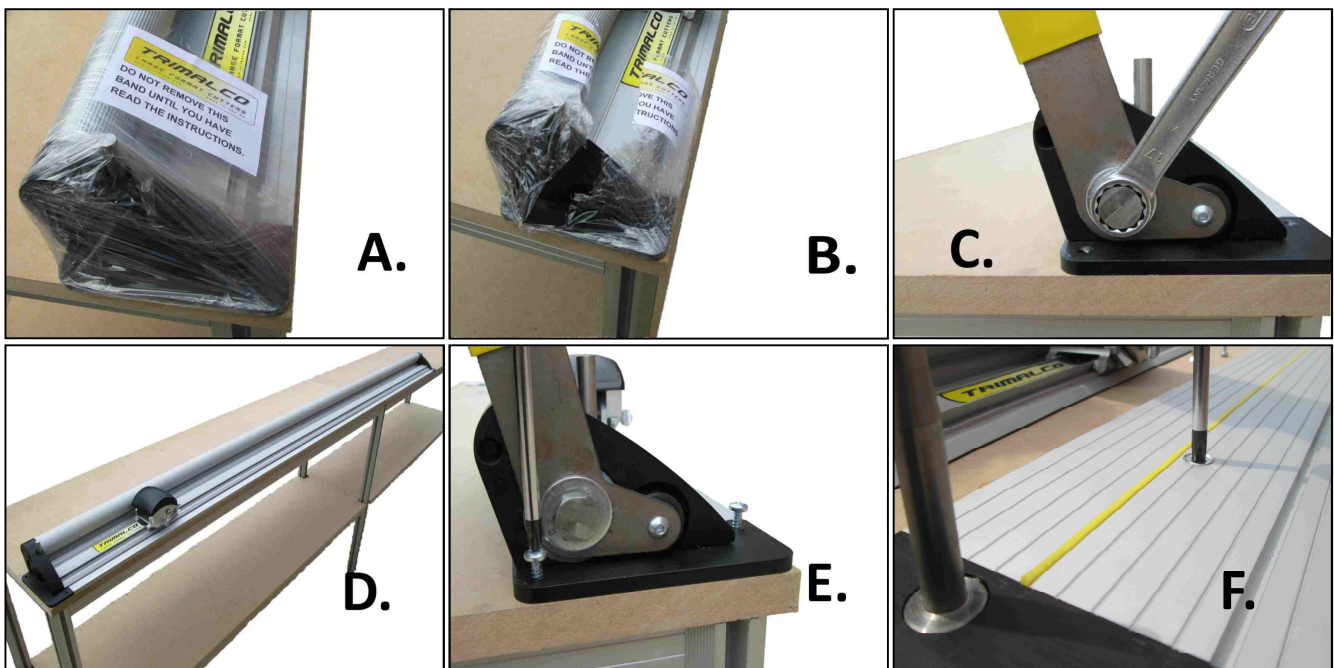

4. OPERATION

- 4.1 Loosen the **BLADE CLAMP THUMB SCREW** (See 1 below) and insert a cartridge. The utility blade and scoring blade cartridges are inserted from the rear of the holder (See 2 below), the textile blade cartridge is inserted from the front (See 3 below).
- 4.2 **UTILITY BLADE** - The utility blade can be located in any one of 4 positions depending on the thickness of material being cut (See 4 below). Fine adjustment can be carried out by undoing the **BLADE CLAMP THUMB SCREW** (See 1 below) and moving the cartridge itself. To cut lightweight materials, place your right hand on the cutter head, depress the cutter and pull the cutting head towards you (See 8 below). To cut heavyweight materials, place your left hand on the circular grip and apply downward pressure, place your right hand on the cutter head, depress the cutter with the palm of your hand and push away from you to cut (See 9 below). Multiple passes may be needed for thicker materials.
- SCORING BLADE** - The scoring blade should be located in the cartridge as shown in 5 below. To score fracture sensitive plastics such as acrylic use the same technique as used for cutting heavyweight materials (see above). To break, move the material so that the score line runs along the front edge of the table and using the cutter as a clamp, apply downward pressure to the overhanging plastic to break. (**SAFETY GLASSES AND GLOVES SHOULD BE WORN**)
- TEXTILE BLADE** - To cut, use the same technique as used for cutting lightweight materials (see above). Blades can be replaced by undoing the knurled brass knob on the rear of the unit.

5. GENERAL MAINTENANCE

- 5.1 Regularly clean the NEMESIS Cutting system using a dry cloth, stubborn stains can be removed with a cloth dampened with a little water/detergent.
- 5.2 Silicon spray can be used to lubricate the cutting head slideway. NEVER USE OIL OR SPIRITS TO LUBRICATE OR CLEAN THE NEMESIS CUTTER RAIL, SOME OF THE PLASTIC COMPONENTS AND BEARINGS MAY BE DAMAGED.

6. ADJUSTING THE CUTTING HEAD BEARINGS

- 6.1 The bearings used to control the **CUTTING HEAD** are made from a high quality polymer and under normal use will last for an extremely long time. As they settle into position you may find a slight amount of side play, this can be removed by tightening the two adjustment screws (See 7 below).

7. SPARE PARTS

- 7.1 Spare parts can be obtained by visiting our website at www.trimalco.com

